

Courses & distances from fallen wo.  
up the River to Beech

- Viz. South. 27 perches
- S 72° E 34
- S 25 E 24.8
- S 17 W 39.5
- S 86 W 10.3
- S 33 W 19.2 to Beech

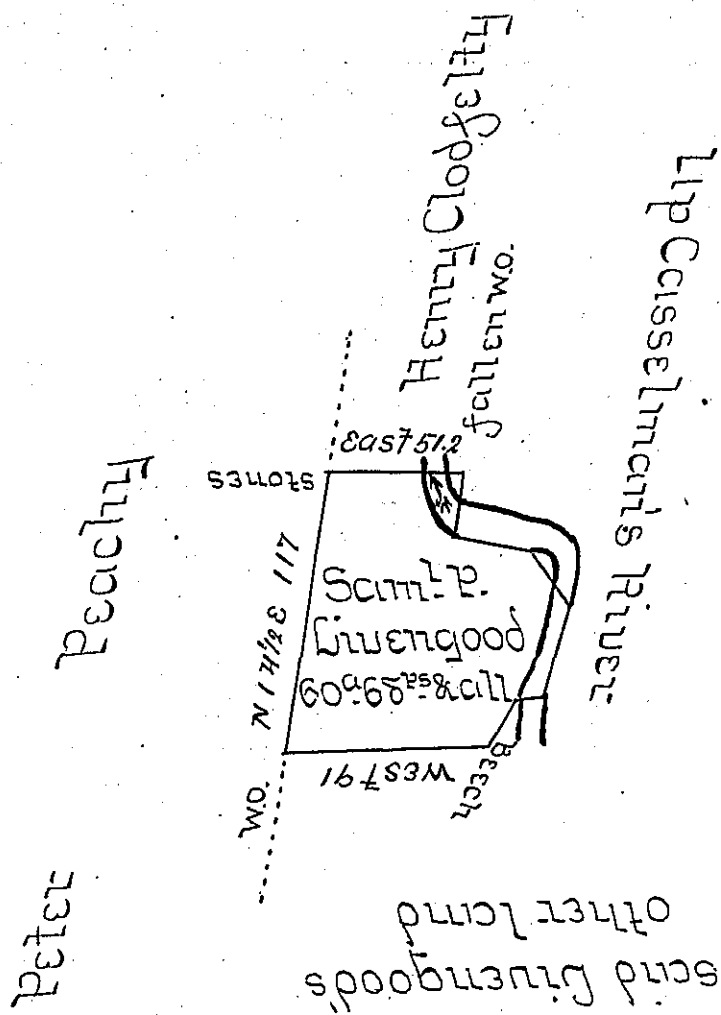

Situate in Elklick Township Somerset County including an improvement and (having been previously surveyed) is now returned the 20<sup>th</sup> day of Dec<sup>r</sup> AN 1837 in pursuance of a Warrant dated the 7<sup>th</sup> Inst<sup>t</sup>

P<sup>r</sup> Bernard Connelly J<sup>r</sup> D S  
Som<sup>r</sup> Co.

To John Taylor Esq<sup>r</sup> S<sup>r</sup> J

IN TESTIMONY that the above is a copy of the original remaining on file in the Department of Internal Affairs of Pennsylvania, made conformably to an Act of Assembly approved the 16th day of February, 1833, I have hereunto set my Hand and caused the Seal of said Department to be affixed at Harrisburg, this ninth day of October 1905.

*Geo. A. R. Brown*  
Secretary of Internal Affairs.